

# WCNAPLES NAPLES - RIMLESS NANO GLAZE TOILET SUITE

WCNAPLES : 620 mm (L) 360 mm (W) 810 mm (H)

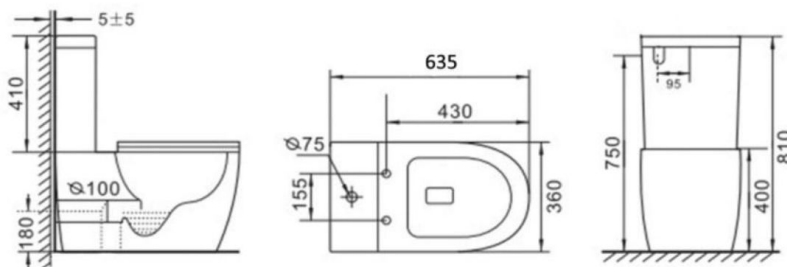

## DIMENSIONS

Length: 620mm | Width: 360mm | Height: 810mm

## DESCRIPTION

The Naples toilet suite is a modern, elegant system that uses cutting edge flushing mechanisms aimed at increasing flushing power and water efficiency.

With it's rimless flushing technology and nano glazed pan, the Naples is one of the most powerful and toughest toilet out there!

Nano glazing surface

Highest quality vitreous ceramic

Slimline Seat (ISC93) - Ergonomic UF and quick release soft close seat

Universal system for both top inlet and bottom inlet

P-Trap: IS15 180mm

S-Trap: IS32 80x135mm

## WARRANTY

5 Year Replacement Warranty / 1 Year Parts & Labour / 1 Year Seat Replacement

- Product replacement does not include installation or removal of the original product
- Check product for damage before installation - installing a damaged product voids warranty

## WELS

Litres Per Minute:	4.5 /3L	Registration Code:	L04710
License Number:	1383	Star Rating:	4 Stars / 6 Stars

## IMPORTANT NOTICE

- The dimensions of all ceramic products may vary from size guidelines due to material properties and the handmade manufacturing process.
- All pictures and drawings on this brochure are representational only, changes in the product may have occurred since time of print.
- All prices on this brochure and The Sink Warehouse website are subject to change without notice.

To contact The Sink Warehouse email us at [info@sinkwarehouse.com.au](mailto:info@sinkwarehouse.com.au)