

VTIA1200 : TIA - VANITY ONLY 1200MM

VTIA1200: 1180mm (L) 455mm (W) 750mm (H)

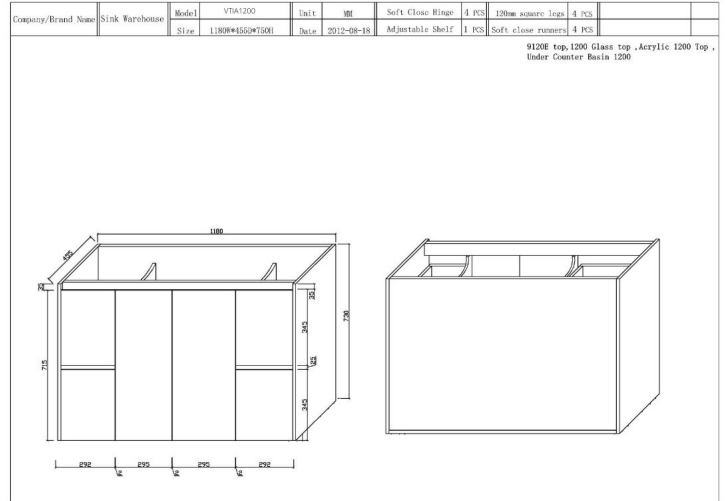

DIMENSIONS
 1180mm length x 460mm depth x 750mm height

DESCRIPTION
 Contemporary bathroom vanity
 High moisture resistant board with a polyurethane/2 pack finish
 No handles
 Soft close doors and drawers
 Available on legs or kickboard

WARRANTY
 1 Year Replacement Warranty
 Product replacement does not include installation or removal of the original product. Check product for damage before installation
 - installing a damaged product voids warranty.

IMPORTANT NOTICE
 Tapware and waste not included.
 It is strongly recommended that any cut-outs made to your bench top is made based on the individual product dimensions.
 All pictures and drawings on this brochure are representational only, changes in the product may have occurred since time of print.
 All prices on this brochure and The Sink Warehouse website are subject to change without notice.

To contact The Sink Warehouse email us at info@sinkwarehouse.com.au