

## KCBD8012: 800mm x 600mm x 730mm

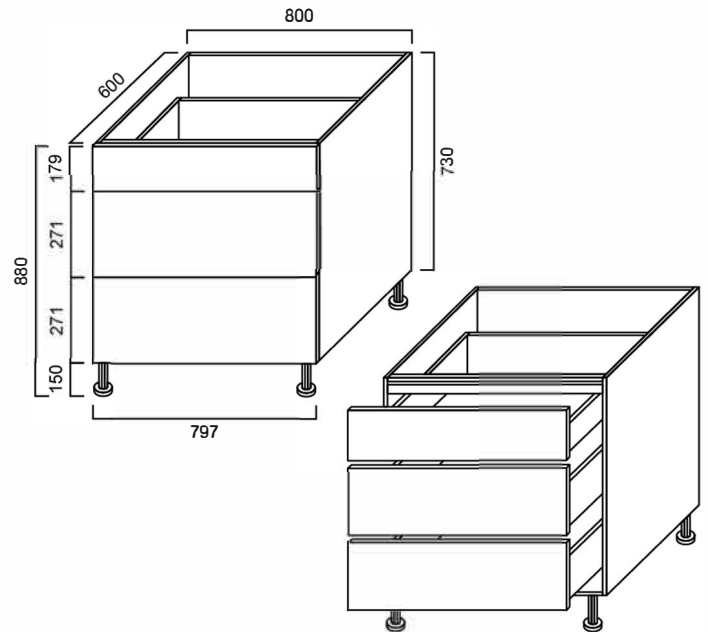

### DIMENSIONS

Length: 800mm | Depth: 600mm | Height: 730mm

### DESCRIPTION

- Contemporary kitchen and laundry drawer unit
- 1 small draw and 2 medium drawers
- 16mm thick, high moisture resistant board
- 2 pac polyurethane construction
- Soft close doors and drawers

### WARRANTY

10 Year Structural Warranty / 5 Year Soft Close Warranty

- Product replacement does not include installation or removal of the original product
- Check product for damage before installation - installing a damaged product voids warranty

### BUYING GUIDE

- All cabinets are sold as just the shell, door and legs.
- You will need to purchase the correct amount of kickboard for the length of your kitchen or laundry. See our panels page for sizes and prices.
- For units going up against a wall or an appliance, you will need to purchase the respective panel. See our panels page for sizes, prices and more information.
- Handles will need to be purchased additionally. See our panels page for different styles and prices.

### IMPORTANT NOTICE

- These cabinets are only available for Perth Metro pick-up and are not available online.
- It is strongly recommended that any cut-outs made to your bench top is made based on the individual product dimensions.
- All pictures and drawings on this brochure are representational only, changes in the product may have occurred since time of print.
- All prices on this brochure and The Sink Warehouse website are subject to change without notice.

To contact The Sink Warehouse email us at [info@sinkwarehouse.com.au](mailto:info@sinkwarehouse.com.au)